

Type Gearbox:

“ZF TRAXON WITH OR WITHOUT RETARDER”

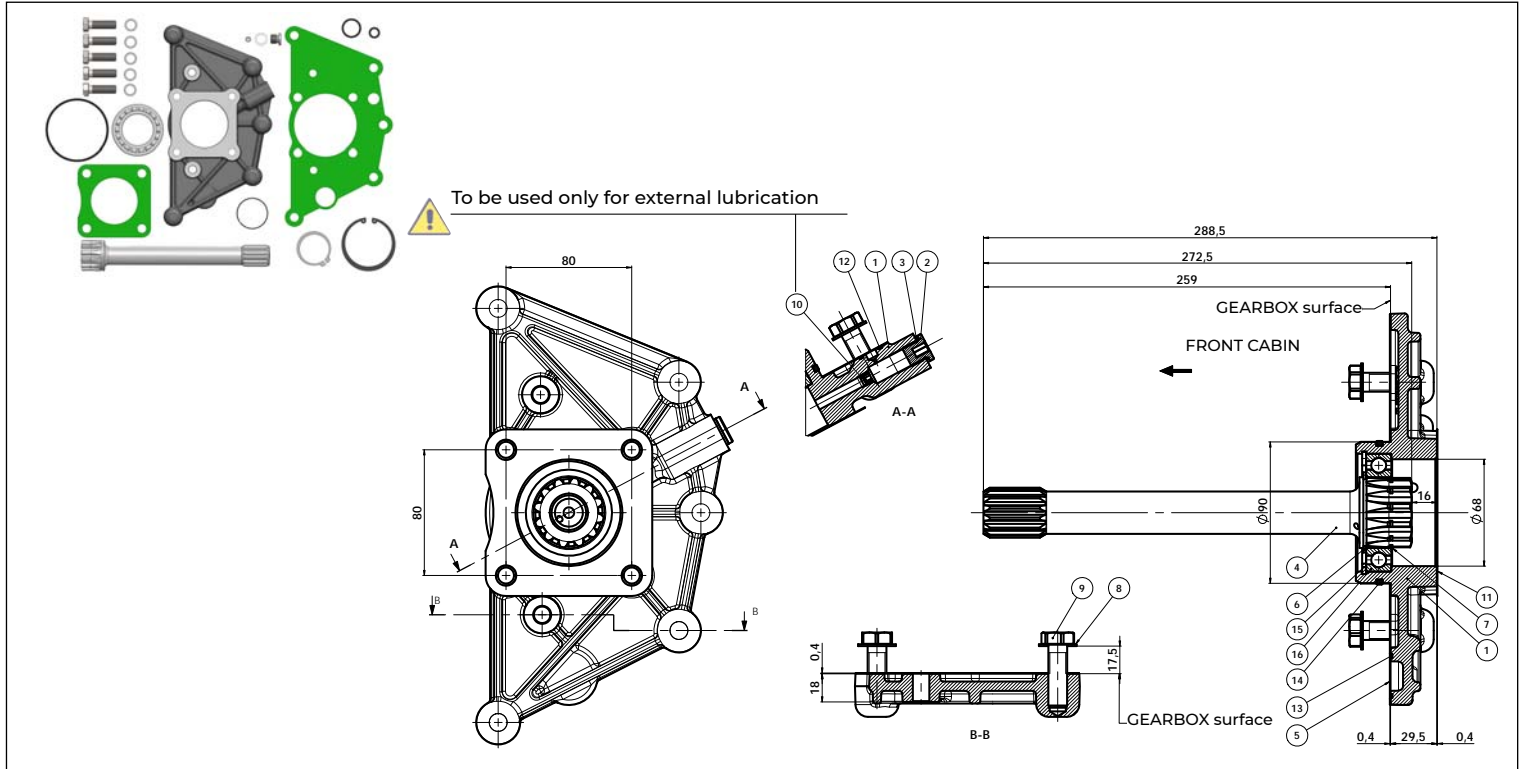

### Spare parts

Pos.	Part.no	Description	Qty.
1		ZF “TRAXON” Flange	1
2		Plug TCE 1/4” DIN 908	1
3		Washer 13,5x18x1,5 (1/4”)	1
4		Quill shaft Z14 L272-ZF16AS2200-INT	1
5		Gasket	1
6		Seeger 45 E UNI 7435	1
7		Ring	1
8		Nord-lock Washer	5
9		Screw TE M12x40 UNI EN 24017	5
10		Conical plug 1/16-27 PTF LEVEL SEAL	1
11		Gasket ISO 7707 Ø68	1
12		Gasket O-R 2050 (1.78x12.42) FKM/FPM	1
13		Gasket O-R 2100 (1.78x25,12) FKM/FPM	1
14		Gasket O-R-M 0840-30 (3x84) FKM/FPM	1
15		Seeger 75 I	1
16		Ball bearing 45x75x16 EUR.6009	1

### General Info

The fitment to the gearbox based on holes spreads the mass moment of PTO/pump assembly equally over more points. The flange is designed to take out pressurised oil from the gearbox through the dedicated port available on the transmission and to get use of it either for internal or external PTO lubrication.

### Related documentation

Mounting instructions:

QUILL SHAFT-0019